

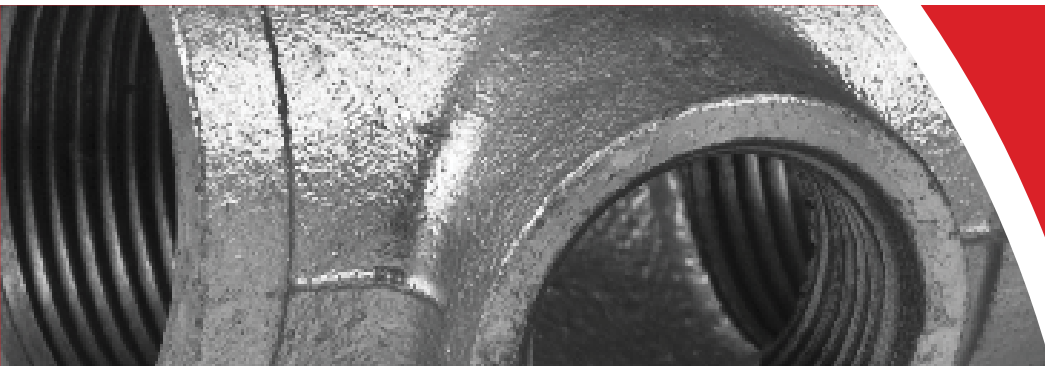

## Catalogue 2011



**longer  
lasting**

**pin hole  
free**



**tapered  
threads**

**ASIB Fire Protection Approved**

[www.minggalv.com](http://www.minggalv.com)



ASIB Fire Protection Approved | ISO 9001:2000 Quality Certified 

**MING®** The **HEAVYWEIGHT** of galvanised fittings continues to grow within the industry and has been forging a solid name for itself these past few months.

Here are some interesting facts about our **MING®** Products:

- Max Pressure : 16 Bar (230Psi) (1.6Mpa)
- Max Temperature : 200°C (392°F)
- Tensile Strength :  $\geq 330$ Mpa
- Hardness :  $\geq$  HB150 (Brinell)
- Elongation Rate :  $\geq 8\%$

Our **MING®** range are heavy duty hot dipped malleable iron fittings. Individual pressure testing is done on each fitting to ensure pin hole free quality.

Each fitting is coated with a light oil to prevent corrosion on threads which conform to ISO 7-1 (BSP Standards) and ensure a perfect seal for the fittings lifetime.

Visit us at

**[www.minggalv.com](http://www.minggalv.com)**

and register for specials  
and information!

The **HEAVYWEIGHT**  
of galvanised fittings

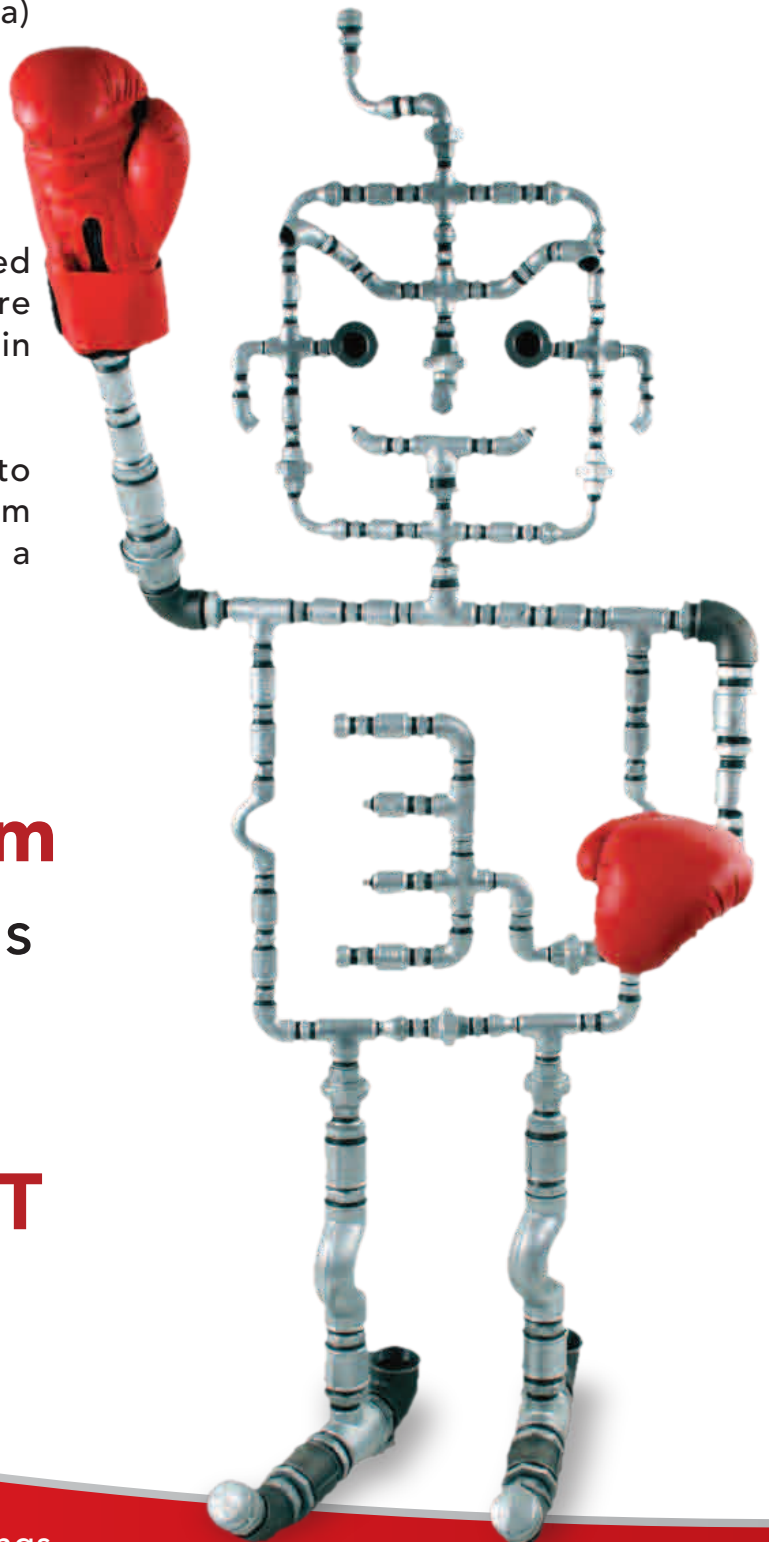

Industrial Galvanised Fittings

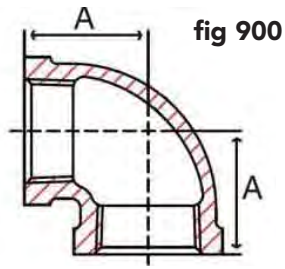

### ELBOW 90°

ITEM CODE	WEIGHT (g)	LENGTH (mm)
900/0008	40	A: 19
900/0010	62	A: 24
900/0015	98	A: 27
900/0020	147	A: 32
900/0025	213	A: 37
900/0032	352	A: 44.5
900/0040	440	A: 49
900/0050	720	A: 57
900/0065	1110	A: 68.5
900/0080	1470	A: 77.5
900/0100	2770	A: 96.5
900/0150	6000	A: 120

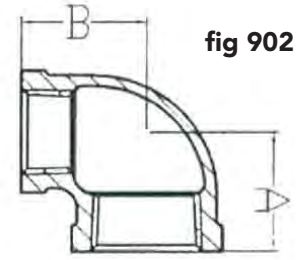

### ELBOW 90° REDUCING

ITEM CODE	WEIGHT (g)	LENGTH (mm)
902/0020x0015	125	A: 29 B: 30
902/0025x0015	163	A: 31 B: 33
902/0025x0020	195	A: 34 B: 35
902/0032x0015	235	A: 34 B: 37
902/0032x0020	264	A: 36 B: 40
902/0032x0025	295	A: 40 B: 45
902/0040x0015	273	A: 35 B: 41
902/0040x0020	310	A: 37 B: 43
902/0040x0025	320	A: 41 B: 45
902/0040x0032	395	A: 45 B: 47
902/0050x0015	400	A: 37 B: 47
902/0050x0025	500	A: 43 B: 51
902/0050x0032	550	A: 47 B: 53
902/0050x0040	630	A: 51 B: 54
902/0065x0032	760	A: 51.5 B: 61
902/0065x0040	840	A: 54.5 B: 62
902/0065x0050	917	A: 59.5 B: 64
902/0080x0040	980	A: 57.5 B: 71
902/0080x0050	1200	A: 61.5 B: 71
902/0080x0065	1300	A: 71.5 B: 74
902/0100x0050	1733	A: 68.5 B: 86
902/0100x0065	2000	A: 77.5 B: 89
902/0100x0080	2200	A: 82.5 B: 90

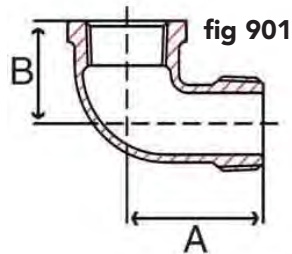

### ELBOW 90° mxf

ITEM CODE	WEIGHT (g)	LENGTH (mm)
901/0015	86	A: 28 B: 38
901/0020	140	A: 33 B: 44
901/0025	205	A: 38 B: 52
901/0032	325	A: 45 B: 60
901/0040	410	A: 50 B: 65
901/0050	676	A: 58 B: 74
901/0065	1080	A: 69 B: 90
901/0080	1550	A: 78 B: 102
901/0100	2800	A: 100 B: 122



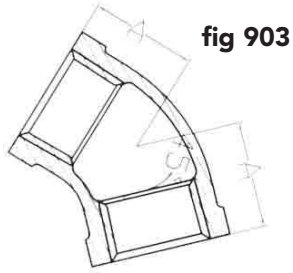

### ELBOW 45°

ITEM CODE	WEIGHT (g)	LENGTH (mm)
903/0015	88	A: 22
903/0020	133	A: 25
903/0025	195	A: 28
903/0032	307	A: 33
903/0040	383	A: 36
903/0050	628	A: 43
903/0065	950	A: 48.5
903/0080	1220	A: 53.5
903/0100	2167	A: 64.5
903/0150	4800	A: 80

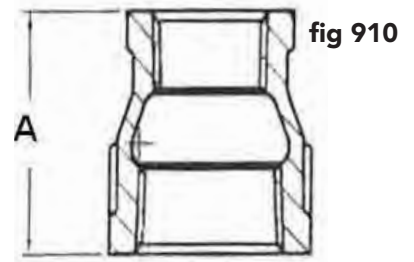

### SOCKET REDUCING

ITEM CODE	WEIGHT (g)	LENGTH (mm)
910/0015x0008	84	
910/0015x0010	73	A: 35
910/0020x0010	87	
910/0020x0015	103	A: 38
910/0025x0015	140	A: 44
910/0025x0020	155	A: 44
910/0032x0015	205	A: 49
910/0032x0020	215	A: 49
910/0032x0025	230	A: 49
910/0040x0015	239	A: 53
910/0040x0020	255	A: 53
910/0040x0025	265	A: 53
910/0040x0032	299	A: 53
910/0050x0015	370	A: 63
910/0050x0020	390	A: 63
910/0050x0025	400	A: 63
910/0050x0032	420	A: 63
910/0050x0040	460	A: 63
910/0065x0025	608	A: 72
910/0065x0032	636	A: 72
910/0065x0040	660	A: 72
910/0065x0050	700	A: 72
910/0080x0040	785	A: 71
910/0080x0050	783	A: 71
910/0080x0065	783	A: 71
910/0100x0040	1325	A: 71
910/0100x0050	1275	A: 84
910/0100x0065	1333	A: 84
910/0100x0080	1367	A: 84



### BEND 90° mx f

ITEM CODE	WEIGHT (g)	LENGTH (mm)
905/0015	117	A: 48 ; B: 42
905/0020	200	A: 55 ; B: 48
905/0025	323	A: 69 ; B: 60
905/0032	570	A: 85 ; B: 75
905/0040	675	A: 105 ; B: 95
905/0050	1217	A: 116 ; B: 105
905/0065	1783	A: 140 ; B: 130
905/0080	3000	A: 176 ; B: 165
905/0100	5600	A: 205 ; B: 190

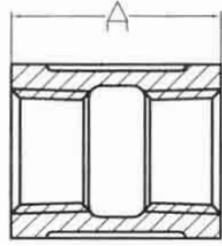

fig 909

**SOCKET**

ITEM CODE	WEIGHT (g)	LENGTH (mm)
909/0008	35	A: 27
909/0010	48	A: 29
909/0015	78	A: 35
909/0020	112	A: 38
909/0025	170	A: 44
909/0032	260	A: 49
909/0040	320	A: 53
909/0050	520	A: 63
909/0065	790	A: 72
909/0080	1020	A: 74
909/0100	1670	A: 84
909/0150	5000	A: 150

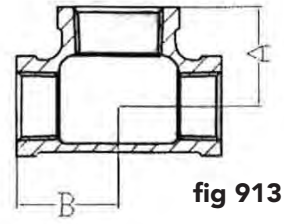

fig 913

**REDUCING TEE**

ITEM CODE	WEIGHT (g)	LENGTH (mm)
913/0020x0015	185	A: 29 B: 90
913/0025x0015	238	A: 31 B: 89
913/0025x0020	273	A: 34 B: 35
913/0032x0015	346	A: 34 B: 74
913/0032x0020	370	A: 36 B: 71
913/0032x0025	426	A: 40 B: 61
913/0040x0015	410	A: 35 B: 59
913/0040x0020	417	A: 37 B: 54
913/0040x0025	490	A: 41 B: 53
913/0040x0032	560	A: 45 B: 51
913/0050x0015	580	A: 37 B: 47
913/0050x0020	600	A: 37 B: 47
913/0050x0025	715	A: 43 B: 47
913/0050x0032	750	A: 47 B: 45
913/0050x0040	820	A: 51 B: 43
913/0065x0025	1100	A: 47 B: 41
913/0065x0032	1200	A: 50 B: 41
913/0065x0040	1230	A: 52 B: 41
913/0080x0050	1563	A: 61.5 B: 40
913/0080x0065	1790	A: 71.5 B: 37
913/0100x0050	2500	A: 68.5 B: 35
913/0100x0065	2700	A: 77.5 B: 33
913/0100x0080	2870	A: 82.5 B: 30

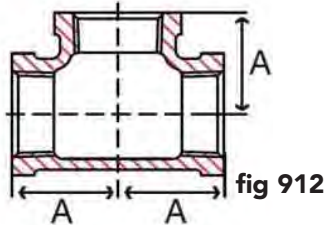

fig 912

**EQUAL TEE**

ITEM CODE	WEIGHT (g)	LENGTH (mm)
912/0008	62	A: 17
912/0010	88	A: 24
912/0015	138	A: 27
912/0020	197	A: 32
912/0025	303	A: 37
912/0032	482	A: 44.5
912/0040	600	A: 49
912/0050	690	A: 57
912/0065	1450	A: 68.5
912/0080	1470	A: 77.5
912/0100	3600	A: 96.5
912/0150	9000	A: 260





fig 914

**BARREL NIPPLE**

ITEM CODE	WEIGHT (g)	LENGTH (mm)
914/0008	18	42
914/0010	20	47
914/0015	40	50
914/0020	61	53
914/0025	96	60
914/0032	158	75
914/0040	202	78
914/0050	273	85
914/0065	402	98
914/0080	540	100
914/0100	840	147



fig 917

**SWAGE NIPPLE**

ITEM CODE	WEIGHT (g)	LENGTH (mm)
917/0015	64	75
917/0020	93	82
917/0025	130	87
917/0032	187	98
917/0040	265	102
917/0050	413	115
917/0065	606	132
917/0080	798	148
917/0100	1275	140



fig 919

**JOHNSON COUPLING**

ITEM CODE	WEIGHT (g)	LENGTH (mm)
919/0015	307	95
919/0020	381	104
919/0025	582	111
919/0032	650	117
919/0040	930	100
919/0050	1185	120



fig 915

**HEXAGON NIPPLE**

ITEM CODE	WEIGHT (g)	LENGTH (mm)
915/0015	59	A: 44
915/0020	88	A: 48
915/0025	140	A: 53
915/0032	220	A: 58
915/0040	230	A: 60
915/0050	370	A: 68
915/0065	580	A: 77
915/0080	780	A: 83
915/0100	1250	A: 98



fig 920

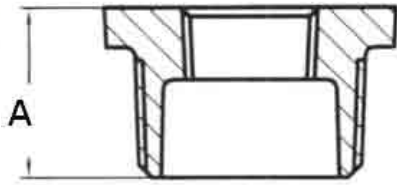

### REDUCING BUSH mxf

ITEM CODE	WEIGHT (g)	LENGTH (mm)
920/0010x0008	22	A: 22
920/0015x0008	37	A: 22
920/0015x0010	35	A: 22
920/0020x0008	51	A: 24
920/0020x0010	51	A: 24
920/0020x0015	51	A: 24
920/0025x0015	99	A: 28
920/0025x0020	84	A: 28
920/0032x0015	175	A: 30
920/0032x0020	157	A: 30
920/0032x0025	130	A: 30
920/0040x0015	220	A: 30
920/0040x0020	217	A: 30
920/0040x0025	192	A: 30
920/0040x0032	130	A: 30
920/0050x0015	305	A: 33
920/0050x0020	304	A: 33
920/0050x0025	365	A: 33
920/0050x0032	315	A: 33
920/0050x0040	255	A: 33
920/0065x0015	485	A: 39
920/0065x0020	450	A: 39
920/0065x0025	478	A: 39
920/0065x0032	544	A: 39
920/0065x0040	540	A: 39
920/0065x0050	450	A: 39
920/0080x0015	623	A: 42
920/0080x0020	630	A: 42
920/0080x0025	660	A: 42
920/0080x0032	670	A: 42
920/0080x0040	692	A: 42
920/0080x0050	760	A: 42
920/0080x0065	520	A: 42
920/0100x0015	1167	A: 49
920/0100x0020	1167	A: 49
920/0100x0032	1175	A: 49
920/0100x0040	1120	A: 49
920/0100x0050	1170	A: 49
920/0100x0065	1280	A: 49
920/0100x0080	1190	A: 49



fig 921

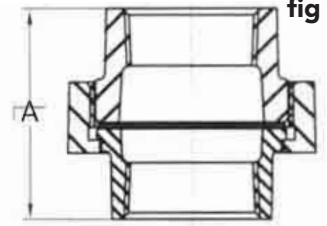

### UNION CONICAL

ITEM CODE	WEIGHT (g)	LENGTH (mm)
921/0015	212	A: 46
921/0020	292	A: 50
921/0025	410	A: 56
921/0032	643	A: 63
921/0040	778	A: 68
921/0050	1215	A: 76
921/0065	1750	A: 83
921/0080	2400	A: 93
921/0100	3834	A: 113.5



fig 922

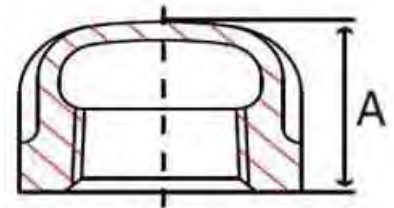

### ROUND CAPS

ITEM CODE	WEIGHT (g)	LENGTH (mm)
922/0015	48	A: 19
922/0020	69	A: 22
922/0025	107	A: 24
922/0032	160	A: 27
922/0040	202	A: 28
922/0050	325	A: 32
922/0065	420	A: 35
922/0080	560	A: 39
922/0100	1033	A: 42

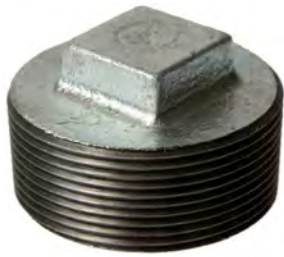
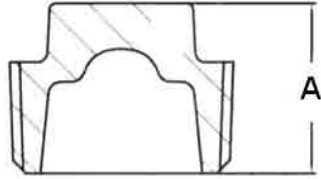

fig 923



**HOLLOW PLUGS**

ITEM CODE	WEIGHT (g)	LENGTH (mm)
923/0010	16	A: 18
923/0015	29	A: 21
923/0020	44	A: 23
923/0025	67	A: 26
923/0032	107	A: 30
923/0040	140	A: 31
923/0050	217	A: 36
923/0065	389	A: 46
923/0080	532	A: 48
923/0100	917	A: 57

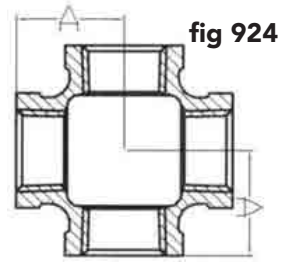

fig 924

**CROSS**

ITEM CODE	WEIGHT (g)	LENGTH (mm)
924/0015	159	A: 27
924/0020	250	A: 32
924/0025	358	A: 37
924/0032	570	A: 44.5
924/0040	708	A: 49
924/0050	1140	A: 57
924/0065	1750	A: 68.5
924/0080	2400	A: 77.5
924/0100	4200	A: 96.5



fig 930

**HOLDERBAT**

ITEM CODE	WEIGHT (g)
930/0015	84
930/0020	120



fig 933

**LONG SCREW COMPLETE**

ITEM CODE	WEIGHT (g)
933/0015	187
933/0020	264
933/0025	397
933/0032	557
933/0040	682
933/0050	907

fig 931



**BACK NUT**

ITEM CODE	WEIGHT (g)	LENGTH (mm)
931/0015	28	A: 9
931/0020	46	A: 10
931/0025	79	A: 11
931/0032	100	A: 11
931/0040	135	A: 12
931/0050	197	A: 13
931/0065	285	A: 15
931/0080	510	A: 15
931/0100	825	A: 17

fig 935



**STEEL SOCKET (BLACK)**

ITEM CODE	WEIGHT (g)
935/0015	65
935/0020	80
935/0025	140
935/0032	190
934/0040	235
934/0050	340

fig 934



**STEEL SOCKET**

ITEM CODE	WEIGHT (g)
934/0015	65
934/0020	80
934/0025	140
934/0032	190
934/0040	235
934/0050	340
934/0065	560
934/0080	665
934/0100	1090

fig 935/0020L



**STEEL SOCKET (55mm LONG)**

ITEM CODE	WEIGHT (g)
935/0020L	121



fig 940

### STANDPIPE

ITEM CODE	WEIGHT (g)
940/015x0150	15mm x 150mm
940/015x0200	15mm x 200mm
940/015x0300	15mm x 300mm
940/015x0400	15mm x 400mm
940/015x0450	15mm x 450mm
940/015x0500	15mm x 500mm
940/015x0600	15mm x 600mm
940/015x0750	15mm x 750mm
940/015x0900	15mm x 900mm
940/015x1000	15mm x 1000mm
940/020x0150	20mm x 150mm
940/020x0200	20mm x 200mm
940/020x0300	20mm x 300mm
940/020x0400	20mm x 400mm
940/020x0450	20mm x 450mm
940/020x0500	20mm x 500mm
940/020x0600	20mm x 600mm
940/020x0700	20mm x 700mm
940/020x0750	20mm x 750mm
940/020x0900	20mm x 900mm
940/020x1000	20mm x 1000mm
940/025x0150	25mm x 150mm
940/025x0200	25mm x 200mm
940/025x0300	25mm x 300mm
940/025x0400	25mm x 400mm
940/025x0450	25mm x 450mm
940/025x0500	25mm x 500mm
940/025x0600	25mm x 600mm
940/025x0750	25mm x 750mm
940/025x0900	25mm x 900mm
940/025x1000	25mm x 1000mm
940/032x0150	32mm x 150mm
940/032x0200	32mm x 200mm
940/032x0300	32mm x 300mm
940/032x0400	32mm x 400mm
940/032x0450	32mm x 450mm
940/032x0500	32mm x 500mm
940/032x0600	32mm x 600mm
940/032x0750	32mm x 750mm

### STANDPIPE

ITEM CODE	WIDTH (mm)
940/032x0900	32mm x 900mm
940/032x1000	32mm x 1000mm
940/040x0150	40mm x 150mm
940/040x0200	40mm x 200mm
940/040x0300	40mm x 300mm
940/040x0400	40mm x 400mm
940/040x0450	40mm x 450mm
940/040x0500	40mm x 500mm
940/040x0600	40mm x 600mm
940/040x0750	40mm x 750mm
940/040x0900	40mm x 900mm
940/040x1000	40mm x 1000mm
940/050x0150	50mm x 150mm
940/050x0200	50mm x 200mm
940/050x0300	50mm x 300mm
940/050x0400	50mm x 400mm
940/050x0450	50mm x 450mm
940/050x0500	50mm x 500mm
940/050x0600	50mm x 600mm
940/050x0750	50mm x 750mm
940/050x0900	50mm x 900mm
940/050x1000	50mm x 1000mm
940/065x0150	65mm x 150mm
940/065x0200	65mm x 200mm
940/065x0300	65mm x 300mm
940/065x0400	65mm x 400mm
940/065x0450	65mm x 450mm
940/065x0500	65mm x 500mm
940/065x0600	65mm x 600mm
940/065x0750	65mm x 750mm
940/065x0900	65mm x 900mm
940/065x1000	65mm x 1000mm
940/080x0150	80mm x 150mm
940/080x0200	80mm x 200mm
940/080x0300	80mm x 300mm
940/080x0400	80mm x 400mm
940/080x0450	80mm x 450mm
940/080x0500	80mm x 500mm
940/080x0600	80mm x 600mm
940/080x0750	80mm x 750mm
940/080x0900	80mm x 900mm
940/080x1000	80mm x 1000mm
940/100x0150	100mm x 150mm
940/100x0200	100mm x 200mm
940/100x0300	100mm x 300mm
940/100x0400	100mm x 400mm
940/100x0450	100mm x 450mm
940/100x0500	100mm x 500mm
940/100x0600	100mm x 600mm
940/100x0750	100mm x 750mm
940/100x1000	100mm x 1000mm



# THE AUTOMATIC SPRINKLER INSPECTION BUREAU (PTY.) LIMITED

# ASIB

1407 IMBALI  
CNR. LOUIS BOTHA AND TUDHOPE AVENUES  
BEREA  
JOHANNESBURG  
2198

TELEPHONE: 011 642 1703  
FACSIMILE: 011 642 1019  
E-MAIL: [asib@asib.co.za](mailto:asib@asib.co.za)  
WEB SITE: <http://www.asib.co.za>

P O BOX 3139  
HOUGHTON  
2041

**CAPE TOWN:** [E ARIEFDIEN](#)  
Cellular Phone: 084 563 0506  
Facsimile: 021 697 5691

**DURBAN:** [T GAMBLE](#)  
Cellular Phone: 082 578 1732  
Facsimile: 031 572 5846  
[G SNEEDON](#)  
Cellular Phone: 082 578 1737  
Facsimile: 031 462 3714

REGISTRATION NUMBER: 1970/0110833/07

REF: *JWLG/jg/GT/F002* DATE: *10<sup>th</sup> of January 2011*

**From:** **J W L Goring - Managing Director**

**E-Mail Address:** [john@asib.co.za](mailto:john@asib.co.za)

## APPROVAL OF FITTINGS

This serves to confirm that **Ming** fittings have been tested against local standards. These have been found to be equal to or better than what is available within the market for fixed fire protection installations. The Ming fittings logo can be identified as that attached to the bottom right hand corner of this letter. We therefore accept and approve the fittings as suitable for use. The ASIB may call for periodic testing of the fittings in order to ensure the quality is maintained but this does not detract from the approval that is now in place.

Assuring you of our best attention at all times.

Yours faithfully,  
**THE AUTOMATIC SPRINKLER INSPECTION  
BUREAU (PTY.) LIMITED**



Digitally signed by John Goring  
DN: cn=John Goring,  
o=ASIB (Pty) Limited,  
ou=ASIB (Pty) Limited,  
email=john@asib.co.za,  
c=ZA  
Date: 2011.01.10  
20:07:11 +02'00'



**J W L GORING**  
*Managing Director*

Directors: J W L Goring (Managing)

N.B: Document modified to exclude importer details





[www.minggalv.com](http://www.minggalv.com)



ASIB Fire Protection Approved  
ISO 9001:2000 Quality Certified